

# SUPER TOUGH NYLON ELEVATOR BUCKETS

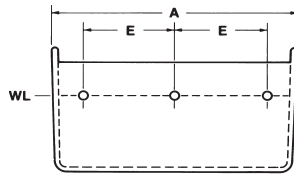

Back View

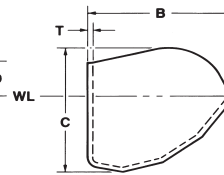

End View

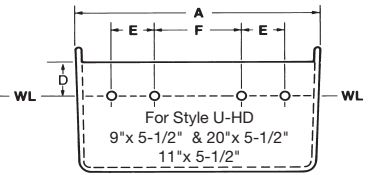

Back View

For Style U-HD  
9"x 5-1/2" & 20"x 5-1/2"  
11"x 5-1/2"

## STYLE CC-HD BUCKETS

SIZE (Nominal) Metric	SIZE (Nominal) Inches	Dimension-Actual (Inches) Tolerance A, B, C ± 3/16" T ± 1/64"				Drilling-Standard (Inches) Tolerance D ± 1/4"					Capacity <sup>①</sup> Tolerance ± 3%				Spacing on Belt (Min.) Inches	Weight (Pounds)		Number Per Carton
		Length A	Proj. B	Depth C	Thickness T	From Top D	Center to Center E	# of Holes	Bolt Diameter	WL	WL + 10%	Cu. In.	Cu. Ft.	Each (Avg.)		Per Carton (Avg.)		
80-60	3 X 2	3-3/8	2-7/16	2-1/4	11/64	7/8	1-3/4		2	1/4	6.2	.0036	6.8	.0039	3	0.14	3.8	24
120-80	4 X 3	4-3/8	3-7/16	3-1/4	3/16	7/8	2-1/2		2	1/4	17.5	.0101	19.3	.0111	4	0.29	7.9	24
140-120	5 X 4	5-7/16	4-9/16	4-3/16	13/64	1-1/4	3-3/16		2	1/4	37.2	.0215	40.9	.0237	5	0.52	14.0	24
160-120	6 X 4	6-7/16	4-9/16	4-3/16	13/64	1-1/4	4-3/8		2	1/4	45.0	.0260	49.5	.0286	5	0.60	15.9	24
180-120	7 X 4	7-7/16	4-9/16	4-3/16	13/64	1-1/4	2-11/16		3	1/4	51.7	.0299	56.9	.0329	5	0.68	17.8	24
160-140	6 X 5	6-1/2	5-9/16	5-3/16	1/4	1-1/2	4-3/8		2	1/4	71.0	.0411	78.1	.0452	6	0.91	23.5	24
180-140	7 X 5	7-1/2	5-9/16	5-3/16	1/4	1-1/2	2-11/16		3	1/4	78.8	.0456	86.7	.0502	6	1.17	29.9	24
200-140	8 X 5	8-1/2	5-9/16	5-3/16	1/4	1-1/2	3-1/16		3	1/4	88.8	.0514	97.7	.0565	6	1.32	33.7	24
230-140	9 X 5	9-1/2	5-9/16	5-3/16	1/4	1-1/2	3-5/8		3	1/4	101.8	.0589	112.0	.0648	6	1.19	30.6	24
260-140	10 X 5	10-1/2	5-9/16	5-3/16	1/4	1-1/2	4-1/8		3	1/4	118.0	.0683	129.8	.0751	6	1.40	35.1	24
280-140	11 X 5	11-1/2	5-9/16	5-3/16	1/4	1-1/2	3		4	1/4	132.3	.0766	145.5	.0842	6	1.46	37.5	24
300-140	12 X 5	12-1/2	5-9/16	5-3/16	1/4	1-1/2	3-3/8		4	1/4	148.8	.0861	163.7	.0947	6	1.78	45.3	24
200-160	8 X 6	8-1/2	6-11/16	6-3/16	1/4	1-3/4	3-1/16		3	1/4	129.5	.0749	142.5	.0824	7	1.42	37.0	24
230-160	9 X 6	9-1/2	6-11/16	6-3/16	1/4	1-3/4	3-5/8		3	1/4	141.3	.0818	155.4	.0899	7	1.68	43.1	24
260-160	10 X 6	10-1/2	6-11/16	6-3/16	1/4	1-3/4	4-1/8		3	1/4	156.4	.0905	172.0	.0996	7	1.86	47.4	24
280-160	11 X 6	11-1/2	6-11/16	6-3/16	1/4	1-3/4	3		4	1/4	180.3	.1043	198.3	.1148	7	1.96	50.1	24
300-160	12 X 6	12-1/2	6-11/16	6-3/16	1/4	1-3/4	3-3/8		4	1/4	192.8	.1116	212.1	.1227	7	2.03	51.8	24
330-160	13 X 6	13-1/2	6-11/16	6-3/16	1/4	1-3/4	3-5/8		4	1/4	212.0	.1227	233.2	.1350	7	2.19	28.5	12
350-160	14 X 6	13-7/8	6-11/16	6	1/4	1-3/4	3		5	1/4	206.2	.1193	226.8	.1313	7	2.49	32.2	12
260-180	10 X 7	10-9/16	7-7/8	7-3/16	9/32	2	4-1/8		3	5/16	228.2	.1321	251.0	.1453	8	2.56	22.9	8
280-180	11 X 7	11-9/16	7-7/8	7-3/16	9/32	2	3		4	5/16	243.6	.1410	268.0	.1551	8	2.76	24.7	8
300-180	12 X 7	12-9/16	7-7/8	7-3/16	9/32	2	3-3/8		4	5/16	258.1	.1494	283.9	.1643	8	2.82	25.2	8
330-180	13 X 7	13-9/16	7-7/8	7-3/16	9/32	2	3-5/8		4	5/16	295.8	.1712	325.4	.1883	8	3.12	27.7	8
350-180	14 X 7	14-9/16	7-7/8	7-3/16	9/32	2	3		5	5/16	314.0	.1817	345.4	.1999	8	3.35	29.3	8
370-180	15 X 7	15-9/16	7-7/8	7-3/16	9/32	2	3-1/4		5	5/16	344.7	.1995	379.2	.2194	8	3.40	30.1	8
400-180	16 X 7	16-9/16	7-7/8	7-3/16	9/32	2	2-7/8		6	5/16	360.4	.2086	396.4	.2294	8	3.69	32.4	8
450-180	18 X 7	18-9/16	7-7/8	7-3/16	11/32	2	3-1/8		6	5/16	412.6	.2388	453.9	.2627	8	4.52	40.2	11
500-180	20 X 7	20-9/16	7-7/8	7-3/16	13/32	2	3-1/2		6	5/16	450.6	.2608	495.7	.2860	8	5.08	46.6	11

## STYLE CC-HD "SUPER CAPACITY" BUCKETS

260-215	10 X 8	10-9/16	8-7/8	8-3/4	11/32	2-1/4	4-1/8		3	5/16	308.9	.1788	339.8	.1966	9	3.10	27.8	8
280-215	11 X 8	11-9/16	8-7/8	8-3/4	11/32	2-1/4	3		4	5/16	338.9	.1961	372.8	.2157	9	3.41	30.3	8
300-215	12 X 8	12-9/16	8-7/8	8-3/4	11/32	2-1/4	3-3/8		4	5/16	376.5	.2179	414.2	.2397	9	3.72	33.1	8
330-215	13 X 8	13-9/16	8-7/8	8-3/4	11/32	2-1/4	3-5/8		4	5/16	405.8	.2348	446.4	.2583	9	4.03	35.6	8
350-215	14 X 8	14-9/16	8-7/8	8-3/4	11/32	2-1/4	3		5	5/16	446.8	.2586	491.5	.2844	9	4.34	38.3	8
370-215	15 X 8	15-9/16	8-7/8	8-3/4	11/32	2-1/4	3-1/4		5	5/16	477.3	.2762	525.5	.3038	9	4.65	40.6	8
400-215	16 X 8	16-9/16	8-7/8	8-3/4	3/8	2-1/4	2-7/8		5	5/16	531.5	.3076	584.7	.3383	9	5.08	41.1	8
450-215	18 X 8	18-9/16	8-7/8	8-3/4	25/64	2-1/4	3-1/8		6	5/16	587.0	.3397	645.7	.3737	9	5.72	50.1	8
500-215	20 X 8	20-9/16	8-7/8	9	13/32	2-1/4	3-1/2		6	5/16	670.0	.3877	737.0	.4265	9	6.47	57.8	8
400-230	16 X 9	16-9/16	10	10-3/16	7/16	2-1/2	2-7/8		6	5/16	639.4	.3700	703.3	.4070	10	6.87	44.4	6
500-230	20 X 9	20-9/16	10	10-3/16	15/32	2-1/2	3-1/2		6	5/16	801.3	.4637	881.4	.5101	10	8.56	54.9	6

## STYLE U-HD BUCKETS fit Universal Industries Elevators

120-80	4 X 3	3-7/8	3	3-1/16	3/16	7/8	1-7/8		2	1/4	11.8	.0065	13.3	.0075	3-1/4	0.23	6.4	24
160-120	6 X 4	6-3/8	4-1/4	4-3/16	13/64	1-1/2	2-3/4		2	1/4	36.8	.0213	40.5	.0235	4-1/4	0.60	15.6	24
180-120	7 X 4-1/2	7-3/8	4-1/2	4-3/16	13/64	1-1/2	2-1/2		3	1/4	46.0	.0266	50.6	.0293	5	0.68	17.5	24
230-150	9 X 5-1/2	9-1/2	5-9/16	5-3/16	1/4	1-3/4	1-3/4	3-1/2	4	1/4	101.8	.0589	112.0	.0650	6	1.19	30.6	24
500-150	20 X 5-1/2	20-9/16	6	5-1/2	13/32	2	1-3/4	3-1/4	7	1/4	163.3	.0945	179.6	.1039	6	3.20	55.5	16
280-160	11 X 5-1/2	11-1/2	6-11/16	6-3/16	1/4	1-3/4	1-3/4	2-3/4	5	1/4	180.3	.1046	198.4	.1151	6	1.96	50.1	24
280-180	11 X 7	11-9/16	7-7/8	7-3/16	9/32	2	3-1/8		4	5/16	243.6	.1410	267.9	.1554	8	2.76	24.7	8
300-215	12 X 8	12-9/16	8-7/8	8-3/4	11/32	2-1/4	3-3/8		4	1/4	376.5	.2179	414.2	.2397	9	3.72	33.1	8
350-215	14 X 8	14-9/16	8-7/8	8-3/4	11/32	2-1/4	3		5	1/4	446.8	.2586	491.5	.2844	9	4.34	38.3	8

① Tapco recommends using WL (water level) fill + 10% for usable capacity. A gross capacity figure is no longer provided as it is inappropriate for rating an agricultural elevator bucket.

② 14 X 6 bucket was designed to fit Hunter Mfg. Grizzly elevators.

③ Universal refers to this bucket as 3-3/4 X 3 in fabricated steel, the buckets are completely interchangeable.

④ Modified (cut down) from an 8" projection bucket.

⑤ Holes Drilled 1/32" Oversize.